

SMD Power Inductor CDEPI106

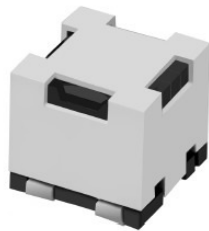

Halogen Free



Description

- Ferrite core construction.
- Magnetically shielded.
- L × W × H: 11.3 × 11.3 × 10.5 mm Max.
- Product weight: 3.6 g (Ref.)
- Moisture Sensitivity Level: 1
- RoHS compliance.
- Halogen Free available.

Environmental Data

- Operating temperature range: -40°C ~ +105°C (including coil's self temperature rise)
- Storage temperature range: -40°C ~ +105°C
- Solder reflow temperature: 260 °C peak.

Packaging

- Carrier tape and reel packaging
- 13.0" diameter reel
- 250pcs per reel

Applications

- Ideally used in digital Amplifier in car audio, home theater and large LCD etc.

Dimension - [mm]

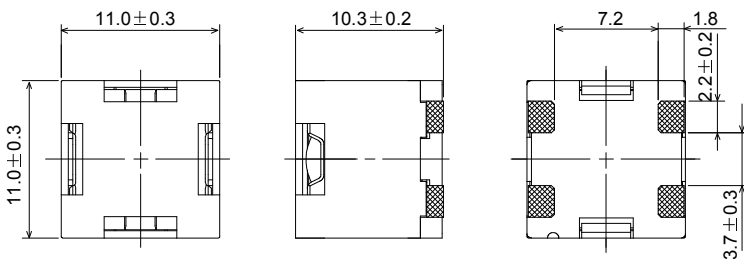

Land pattern and Schematics - [mm]

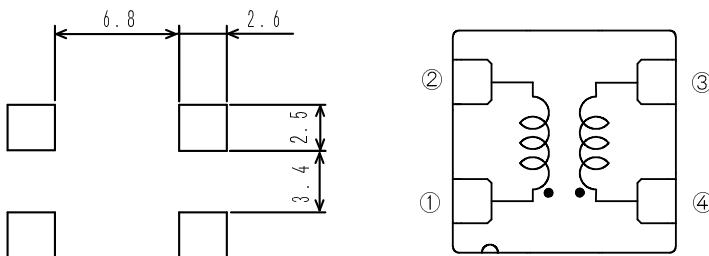

Electrical Characteristics

PART NAME	STAMP	INDUCTANCE [WITHIN] ※1		D.C.R. (mΩ) [MAX.] (Typ.) (at 20°C)		THE SATURATION CURRENT (A) ※2		HEATING CURRENT (A) ※3
		BETWEEN 1-2	BETWEEN 4-3	BETWEEN 1-2	BETWEEN 4-3	(at 20°C)	(at 105°C)	
CDEPI106NP-100	100	10 μH ± 25%	10 μH ± 25%	28.8(23.0)	28.8(23.0)	4.9	4.5	4.0
CDEPI106NP-150	150	15 μH ± 25%	15 μH ± 25%	28.8(23.0)	28.8(23.0)	3.5	3.0	4.0
CDEPI106NP-220	220	22 μH ± 30%	22 μH ± 30%	28.8(23.0)	28.8(23.0)	2.2	1.9	4.0

※1. Measuring condition: at 100kHz.

※2. Saturation current: The value of D.C. current when the inductance decreases to 75% of its nominal value.

※3. Heating current: The value of D.C. current when the temperature rise is Δt = 40°C (Ta = 20°C).

SMD Power Inductor CDEPI106



Saturation Current & Temperature Rise Graph

— L (20°C) — L (105°C) — ΔT

1. CDEPI106NP-100

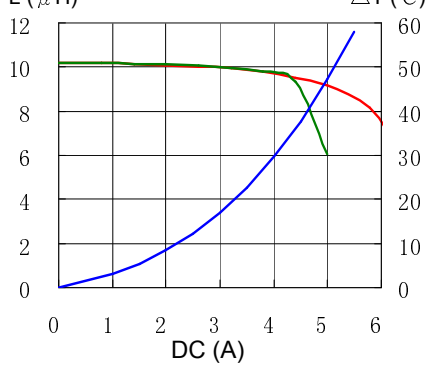

2. CDEPI106NP-150

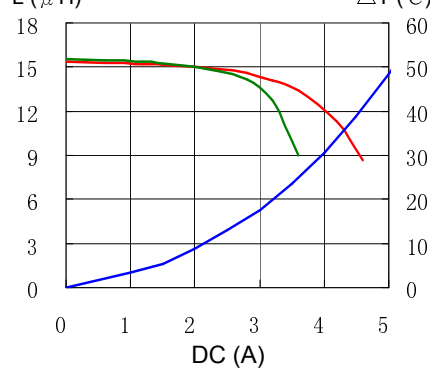

3. CDEPI106NP-220

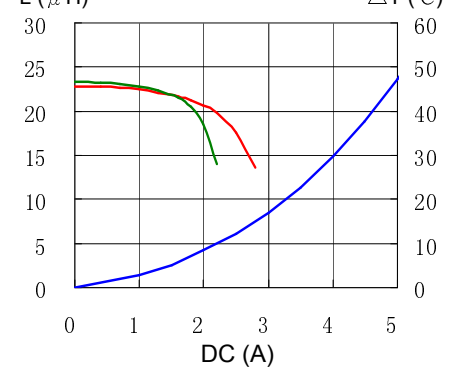

Solder Reflow Condition

