

| | |
|-----------------------|-----------------------|
| Power Inductor | HPC4018 Series |
|-----------------------|-----------------------|

1. Features

1. This specification applies Low Profile Power Inductors.
2. 100% Lead(Pb) & Halogen-Free and RoHS compliant.



2. Dimension

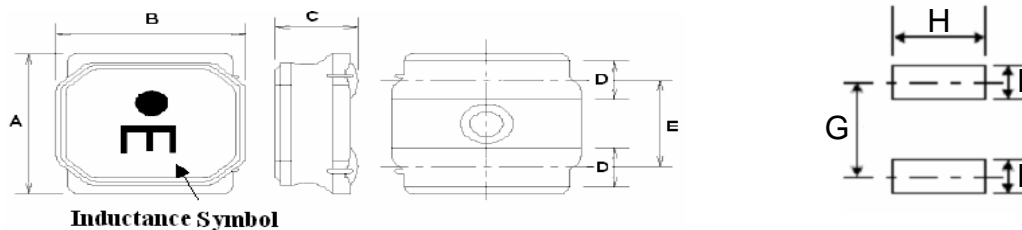

| Series | A(mm) | B(mm) | C(mm) | D(mm) | E(mm) | G(mm) | H(mm) | I(mm) |
|----------|---------|---------|----------|---------|---------|----------|----------|----------|
| HPC4018B | 4.0±0.2 | 4.0±0.2 | 1.8 max. | 1.1±0.2 | 2.5±0.2 | 2.8 ref. | 3.7 ref. | 1.2 ref. |

Units: mm

3. Part Numbering

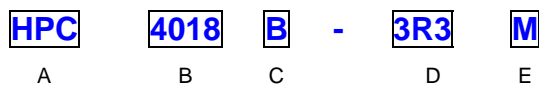

- A: Series
- B: Dimension
- C: Control S/N
- D: Inductance 3R3=3.3uH
- E: Inductance Tolerance M=±20% : Y=±30%

4. Specification

| TAI-TECH Part Number | Inductance Symbol | Inductance (uH) | Tolerance (%) | Test Frequency (Hz) | SRF (MHz) min. | DCR (Ω) $\pm 20\%$ | I sat (A) | I rms (A) |
|----------------------|-------------------|-----------------|---------------|---------------------|----------------|-----------------------------|-----------|-----------|
| HPC4018B-1R0Y | A | 1.0 | $\pm 30\%$ | 1V100K | 90 | 0.027 | 4.00 | 3.20 |
| HPC4018B-1R5Y | B | 1.5 | $\pm 30\%$ | 1V100K | 75 | 0.037 | 3.3 | 2.40 |
| HPC4018B-2R2M | C | 2.2 | $\pm 20\%$ | 1V100K | 60 | 0.042 | 3.00 | 2.20 |
| HPC4018B-3R3M | E | 3.3 | $\pm 20\%$ | 1V100K | 45 | 0.055 | 2.30 | 2.00 |
| HPC4018B-4R7M | H | 4.7 | $\pm 20\%$ | 1V100K | 35 | 0.070 | 2.00 | 1.70 |
| HPC4018B-6R8M | I | 6.8 | $\pm 20\%$ | 1V100K | 30 | 0.098 | 1.60 | 1.45 |
| HPC4018B-100M | K | 10 | $\pm 20\%$ | 1V100K | 25 | 0.150 | 1.30 | 1.20 |
| HPC4018B-150M | M | 15 | $\pm 20\%$ | 1V100K | 18 | 0.210 | 1.10 | 0.85 |
| HPC4018B-220M | N | 22 | $\pm 20\%$ | 1V100K | 15 | 0.290 | 0.90 | 0.72 |
| HPC4018B-330M | P | 33 | $\pm 20\%$ | 1V100K | 12 | 0.460 | 0.70 | 0.55 |
| HPC4018B-470M | S | 47 | $\pm 20\%$ | 1V100K | 10 | 0.650 | 0.60 | 0.44 |
| HPC4018B-680M | T | 68 | $\pm 20\%$ | 1V100K | 8.3 | 1.000 | 0.52 | 0.32 |
| HPC4018B-101M | V | 100 | $\pm 20\%$ | 1V100K | 6.5 | 1.450 | 0.42 | 0.28 |
| HPC4018B-151M | W | 150 | $\pm 20\%$ | 1V100K | 5.5 | 2.300 | 0.34 | 0.22 |
| HPC4018B-221M | X | 220 | $\pm 20\%$ | 1V100K | 4.0 | 3.800 | 0.275 | 0.17 |

Note:

I_{sat} : Based on inductance change ($\Delta L/L0 : \leq -30\%$) @ ambient temp. 25°C

I_{rms} : Based on temperature rise ($\Delta T : 40^\circ\text{C}$ typ.)